

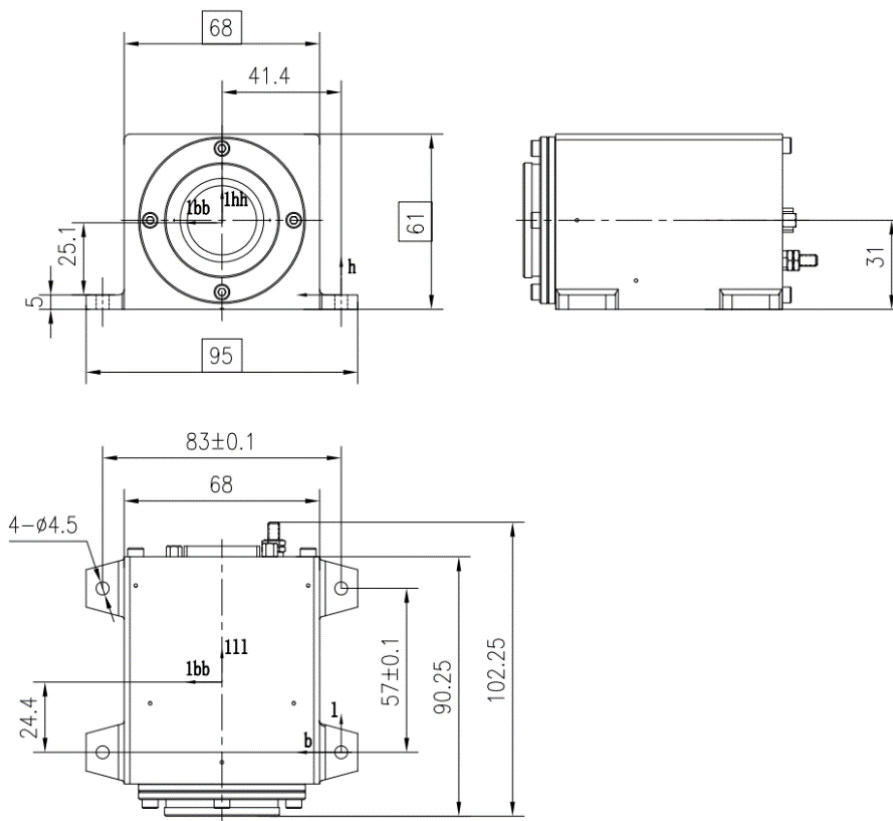

PRODUCT DESCRIPTION

OCE's aerospace miniature camera is designed to be mounted on a spacecraft platform and used to image the important part of the satellites or spacecraft. It provides image-based health diagnosis for improved safety and reliability of the spacecraft.

The camera is composed of optical lens (including protective and imaging lens), circuit components, and housing. Its working principle is as follows: optical lens focuses image on the sensor, where spatial discrete sampling of the image is performed and converted to the corresponding digital image. This image is then compressed to standard JPEG format and sent by serial communication to the interface board. A protective lens arrangement is used to provide radiation protection for the imaging lens and circuit components. The housing structure is used to support all components as well as provide radiation protection.



CMV

Aerospace miniature camera

SPECIFICATIONS

Image resolution (pixels)	Dynamic	320×240
	Static	640×480
Field of view (degrees)		90°
Imaging distance (m)		1~5
Color		Multicolor
Compression format		JPEG
Interface		RS422
Frame frequency (fps)		Dynamic shooting: < 3 fps
Temperature (degrees centigrade)		Storage: -10°C~+60°C
		Operation: -5°C~+55°C
Mass (kg)		0.8
Size (mm)		90.25×68×61
Power (W)		1.0
Life (years)		> 5
Flight heritage		Multiple Missions
Orbit		LEO/MEO

All registered trademarks are respected

For further details email or call:

Sales Department, O.C.E. Technology Ltd.,
NovaUCD, Belfield Innovation Park,
Belfield, Dublin 4,
D04 X8W9, Ireland.

Phone: +353 1 716 3530
Email: sales@ocetechnology.com



Distributor:-

